

Fifth Annual California Council, The American Institute of Architects

MONTEREY DESIGN CONFERENCE

S E C R E T S

March 30-April 1, 1984

Exclusively for Conference

*Professionals Reveal
Design Methods and
Formulas*

*Special Feature:
1984 CCAIA
Honor Awards*

Mystery speaker (shown above) reveals one of the Architectural SECRETS featured during this year's Conference.

Monterey Welcomes Design Conference

Monterey — Attendees of the fifth annual Monterey Design Conference, sponsored by the California Council, The American Institute of Architects, will find the Monterey Peninsula eager to welcome visitors to its restaurants, entertainment spots, shopping areas and unique points of interest during the March 30-April 1 Conference.

Conference activities at the Monterey Conference Center and Doubletree Inn include a myriad of lectures, informal discussion sessions and special events showcasing architectural design and the design considerations of cross-disciplinary professionals.

Members of the Monterey Design Conference Committee have added more op-

portunities for attendees to participate during the question and answer sessions, and, according to a reliable source, "The Conference is the one time each year that architects have the chance to examine their colleagues' work from the beginning stages to project completion. Uncovering their secrets and the opportunity to network at

the Conference are of immeasurable value."

Next year's Conference moves to Asilomar Conference Center in Pacific Grove. Wind twisted trees, shifting sand dunes and the rustic atmosphere set the stage for a relaxing yet stimulating conference experience February 22-24, 1985.

— ED SOHL, AIA
Conference Chair



Conference Program Framed By "SECRETS" Theme

By Rob Wellington Quigley, AIA

Spys won't be lurking in the alcoves during "Secrets," in fact, curious architects and others can be expected to be up front in their quest for the best seats in the house.

The most popular programs of past Monterey Design Conferences have been retained, and expanded to include YOU. Not only will the team presentations by architects be repeated on two separate days, but each presenter will be given more time to show his/her work. You will have a chance to scrutinize their design processes and probe for their secrets during the question and answer sessions.

A special focus on the cross-disciplines of set design, sculpture and glass art will

provide insights into allied professions and reveal the influence of architecture on their work.

Intrigued by the assignment of program chair for the Conference, I said, "Yes, sure, I'll help arrange the program. I can really have fun with this." Your experiences during the Conference, while designed to be educational, informative and valuable, are also meant to be fun.

What should you expect from this year's Conference? The unexpected....

Design Excellence On Display

A number of California Chapters of the American Institute of Architects will show slides of their members' award winning projects. A self-operated, table top viewing projector will be located at the kiosk in the Steinbeck Lobby for continuous viewing throughout the Conference.

Static exhibits also will be available for viewing at the Conference Center. Architectural plans, artist's renderings, photographs and models will be featured, as well as a display of the 1984 CCAIA Honor Awards.

Monterey Design Conference Moves To Asilomar

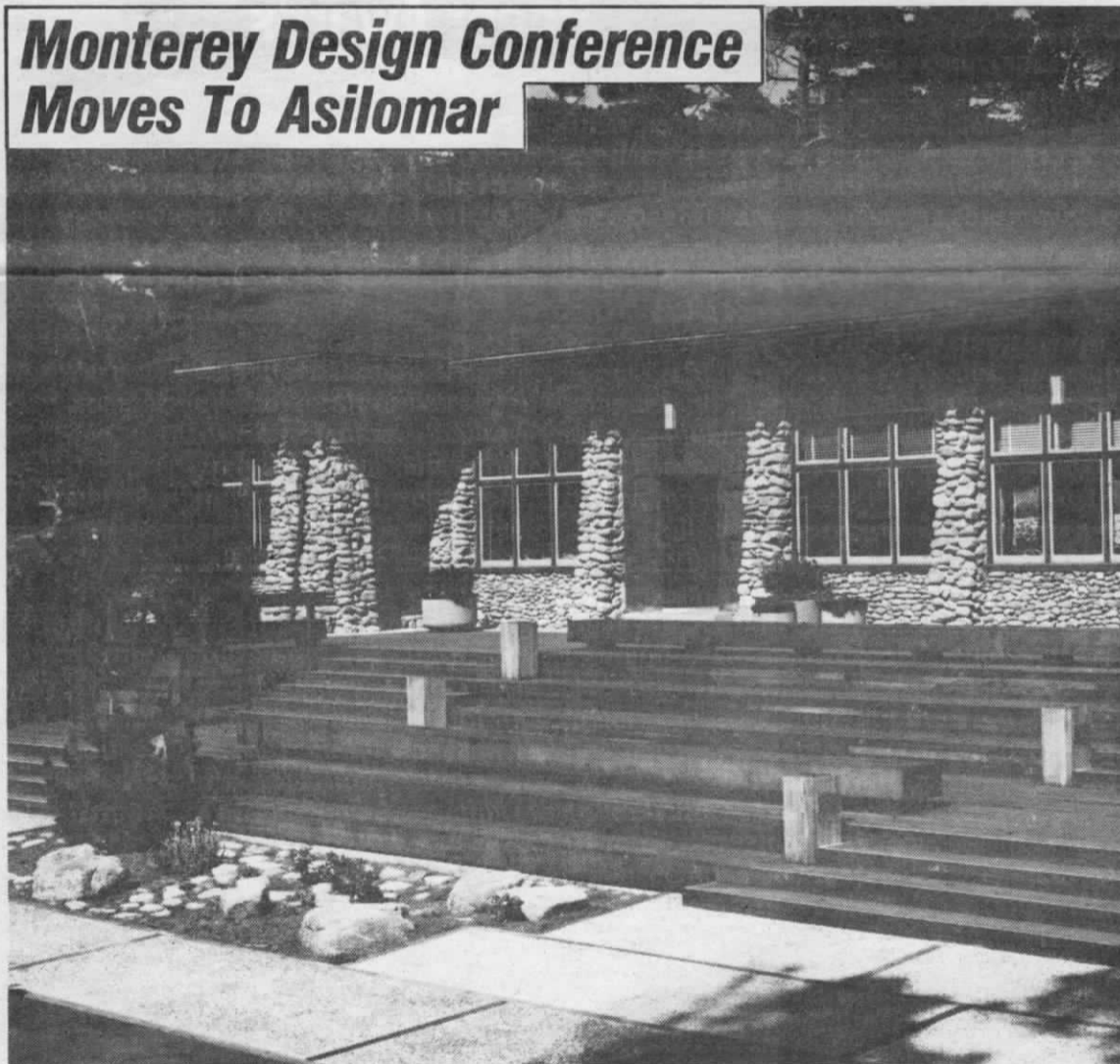

Asilomar Conference Center, a unit of the California State Park System, will be the site for next year's annual CCAIA Design Conference to be held February 22-24.

According to CCAIA's Vice President of Education/Professional Development William McCulloch, AIA, "Asil-

omar is a complete facility which provides space for as many as 850 people seated auditorium style, and up to 750 reasonably priced sleeping accommodations. It's an ideal conference center, located on 105 acres of forest, dune and beach at the tip of the Monterey Peninsula. Not only will

CCAIA be able to accommodate an increase in attendance, but there will be ample space for small discussion groups."

Douglas Austin, AIA, Chair of the 1985 Conference, will begin planning next year's event immediately following this year's Conference.

Top Priority Information

CONFERENCE REGISTRATION DESK HOURS

Friday 10:00 am - 7:00 pm
Saturday 7:30 am - 6:30 pm
Sunday 8:30 am - Noon

The Registration Desk is located in the Portola Lobby of the Monterey Conference Center (First Level).
Registration Desk/Message Center Telephone: 408/646-3792.
Registration Assistants: Sandy Burghdorf, Carol Clayton, and Jan Eding.

TICKET SALES

Honor Awards Roast — Friday, 6:30 pm — \$20.00 (Not included in registration fee).

Intimate Architecture Luncheon — Saturday, Noon — \$10.00 (Included in registration fee; limited tickets available for non-registered guests).

Due to the caterers guarantee requirements, only a limited number of tickets can be sold on site. Please check with the Registration Desk for ticket availability.

PLEASE BRING THE APPROPRIATE TICKET TO FOOD FUNCTIONS. TICKETS ARE REQUIRED FOR ADMISSION.

IDENTIFICATION BADGES

Only those fully registered for the Conference will receive identification badges, which serves as admission passes to the Conference presentations.

SECRETS Monterey Design Conference

Conference Chair: Ed Sohl, AIA
Conference Program Chair: Rob Wellington Quigley, AIA
Conference Committee Members: Douglas Austin, AIA; Kenneth Coker, AIA; A. P. DiBenedetto, FAIA; Susan Harris, Associate; James McGranahan, FAIA; Brian Sehnert, AIA; Donald J. Stastny, AIA, AICP; Donald E. Wudtke, FAIA; Cheryl Thompson, Student.
Conference Consultant: Kathryn Atkinson
CCAIA President: Harry Jacobs, AIA
CCAIA First Vice President: Virgil R. Carter, AIA
CCAIA Secretary: Cyril Chern, AIA
CCAIA Treasurer: Harry B. Haimovitch, AIA
CCAIA Vice President, Education/Professional Development: William C. McCulloch, AIA
CCAIA Vice President, Governmental Relations: Ralph H. Bradshaw, Jr., AIA
CCAIA Vice President, Communications/Public Awareness: Warren D. Thompson, AIA
CCAIA Executive Vice President: Paul W. Welch, Jr.

WEAR YOUR BADGE AT ALL TIMES. REPORT ITS LOSS TO THE REGISTRATION DESK IMMEDIATELY.

CANCELLATIONS/ REFUNDS

CCAIA must guarantee and honor its commitment with the Conference Center and other service providers; therefore, there can be no cancellations or refunds after March 16, 1984.

PRESS ROOM HOURS

Friday Noon - 5:30 pm
Saturday 7:30 am - 5:30 pm
Sunday 8:30 am - Noon

Working press are requested to check in at the Dana Room located on the mid level of the Conference Center. Conference Media Coordinator Vicki Thacker will provide press kits and assist with media requests.

Press Room Telephone: 408/646-3793

SOUVENIRS

Posters: Flat copies of the "Secrets" poster, suitable for framing are on sale at the Registration Desk. Posters \$5.00, Travel/Mailing Tubes \$1.00.

T-shirts: Specially designed Conference T-shirts are on sale at the Registration Desk, while supplies last. Limited quantities available in men's adult sizes small, medium, large and extra-large for \$7.00.

POINTS OF INTEREST

Please check your registration packet for your copy of The Monterey Convention Guide, featuring area maps, restaurant listings and information on visitor attractions.

Guests of the Doubletree Inn may visit the

Guest Services Booth, located in the hotel lobby, for assistance with dinner reservations, babysitting services, etc.

AUDIO/VISUAL

Audio/visual assistance for program presenters is provided by **Ross Hutchings**, Conference A/V Technician. Please inform the Registration Desk if you require his assistance.

STATIC DISPLAYS

Please note that all displays must be dismantled and removed from the Conference Center before 2:00 pm on Sunday, April 1.

ACKNOWLEDGEMENTS

CCAIA is sincerely grateful to the following:

Geraghty & Landskron, Santa Rosa, CA: Conference Banners
The Dunlavey Studio, Sacramento, Ca: Conference Graphics

Team Session Moderators:

Douglas Austin, AIA, Solana Beach, CA; **Stanley F. Keniston**, AIA, San Diego, CA; **Professor Donald Koebert**, San Luis Obispo, CA; **Donald J. Stastny**, AIA, AICP, Portland, OR; and **Rob Quigley**, AIA, San Diego, CA.

Bernard Zimmerman, FAIA, Los Angeles, CA: Honor Awards Roast Master of Ceremonies.

Dan Kiley, Charlotte, VT: Honor Awards Juror.

W. C. Muchow, FAIA, Denver, CO: Honor Awards Jury Chairman.
David H. Wright, AIA, Seattle, WA: Honor Awards Juror.

James G. Pulliam, FAIA, Los Angeles, CA: Honor Awards Committee Chair.



Long Beach Convention Center

Long Beach Site For 1984 CCAIA Annual Convention

A new and exciting Long Beach will host the 39th Annual Convention of the California Council, The American Institute of Architects October 11-14, 1984. The Hyatt Regency Long Beach, with its soaring atrium, deluxe accommodations and the amenities of a truly first-class hotel, has been selected as the Convention headquarters hotel. The new Long Beach Convention and Entertainment Center, adjacent to the Hyatt, is the site for exhibits and keynote presentations.

Convention Chair **Kenneth S. Wing, Jr.**, AIA of Long Beach said, "The Committee is well underway in planning a very special experience for attendees." A dynamic program on the future of architecture and education will provide the forum for presentations by futurists, historians, educators

and leaders in technology. Two unique social events will long be remembered, a private dinner party in the breathtaking Howard Hughes Flying Boat Expo, known as the "Spruce Goose," and an evening aboard one of California's most unusual hotels, the R.M.S. Queen Mary. Names like Gable, Astaire and Churchill are likely to come to mind as you enjoy an elegant evening of dining and dancing in the ship's Grand Salon.

Wing added, "The Cabrillo Chapter AIA is delighted with the opportunity to welcome CCAIA members to a 'new' Long Beach. The redevelopment here has virtually transformed the City into a playground by the sea."

Convention information will be distributed to the CCAIA membership this summer.

HIDDEN TREASURES IN THE URBAN LANDSCAPE

Under the San Diego silhouette
Lies an art form of etiquette
Stuffed with broken layers of lost bets
And old issues of yellowed gazettes

Development tends to forget

Besieged by the Destroyer's bayonet
Eradicating ribbons of glass epaulet
Voices were heard as striking annulets
And young warriors armed with amulets

Purpose fought with beaded sweat

From Gaslamp Quarter's buccaneer pirate
To Campus Drive-in's billboard parapet
Artist and Destroyer formed electric duets
And conspired to save the neon alphabets

Saviors come to meet the threat

Out of the gaseous rainbow vignette
Comes treasure reborn for the urban set
Floating art in twisting rivulets
With roses, hot pinks and violets

SONO is the secret

Milford Wayne Donaldson
1983

"SECRETS" Program

Friday, March 30, 1984

1:00 pm CONFESSIONS

Steinbeck Forum —

Sources close to the President said, "Harry Jacobs, AIA will open the Conference with a challenge to the profession to examine the use of the terms design, architecture and creativity." President Jacobs is expected to remark on some very provocative design issues.

In the President's footsteps, Conference Chair Ed Sohl, AIA will conduct an undercover briefing session with the audience.

1:20 pm ARCHITECTS KEPT IN THE DARK

Steinbeck Forum —

This innovative slide presentation is just a peek through the keyhole at the architecture and art to be fully exposed later in the Conference.

1:30 - 2:15 pm ILLUSIONS

Steinbeck Forum —

Set Designer **Robert Israel** examines the limitations and freedoms of set design in relation to current projects. Major theater and costume designs include two operas by Philip Glass, "Satyagraha," which premiered in Holland and is playing New York, and "Akhnaton," which opens in Houston in October.

"The role the stage plays in determining what forms will be used on it can be compared to the role landscape plays in determining the design of a structure," Israel said.

Educated in the arts of painting and sculpture, he began his career in set design in 1963 at the Guthrie Theater in Minneapolis. He has worked and lived in Europe and the

United States and currently resides in Venice, California. Israel also serves on the faculty at the University of California at San Diego.

2:15 - 2:30 pm EAVESDROPPING

A brief intermission...

2:30 - 3:50 pm UNVEILING SECRETS

OPTION A

Steinbeck Forum —

Richard P. Dalrymple, AIA of Pacific Associates Planners Architects, Inc. (PAPA) in San Diego, presents "Sources of Architectural Inspiration" — secret sources not normally observed or considered which are related to architecture. He shows how they influence him and how other designers can make use of them. Dalrymple said, "We will discuss how these ideas can be translated, manipulated and transformed into architectural inspiration."

PAPA's projects range from a small local remodel to major mix-use projects in the Orient. Although a relatively young firm, it has established itself as a sensitive design firm known for recognizing and capitalizing on project opportunity, sound solutions to tough problems, and engaging designs.

Steven D. Ehrlich, AIA, of Steven David Ehrlich Architects AIA in Venice, speaks on "The Evolution of Post-Primitivism." Ehrlich said, "Post-primitivism is an architecture that is sensuous yet simple, evocative yet orderly, romantic yet rational." Slides of remote areas of the Sahara Desert will depict buildings of extraordinary strength and



Richard P. Dalrymple, AIA



Steven D. Ehrlich, AIA



Wade Killefer, AIA



John V. Mutlow, AIA

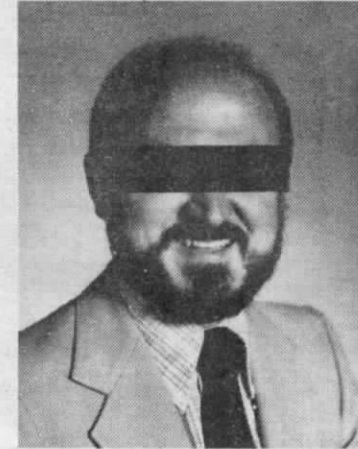

Scott L. Danielson, AIA



Stephen Gegner, AIA

grace, such as mosques, a grain bank and the Dogon Settlements in Mali. Post-primitive architecture also will be exposed in several current projects including the award winning Swan House and the World Savings and Loan project currently under construction.

Ehrlich is the recipient of numerous design awards from the Los Angeles Chapter AIA, Sunset and the California Council AIA. Current and past projects include film studios, a university theater, manufacturing plants, office and financial complexes and a multitude of single and multi-family residential work.

Wade Killefer, AIA, of Carde/Killefer Corporation in Santa Monica, presents "Design/Build, or The Secret of Saving Your Ass for Fun & Profit." Slides of projects built for Rob Quigley, Charles Moore, Charles Jencks, Frank Gehry and Gwathmey Siegal will be shown. Killefer said, "For the remaining portion, we'll show our own work and discuss whose fault it is."

The Carde/Killefer Corporation was started in 1975 by Carde and Killefer who met as classmates at the UCLA Graduate School of Architecture. With backgrounds in construction, they began their design/build practice as a means to combine the architectural and construction phases of the building process. The firm currently is active in design and construction of commercial and residential buildings.

John V. Mutlow, AIA, of Mutlow Dimsiter Partnership in Los Angeles, comments on "The influences of Culture and Regionalism." He describes the direct effects culture and personal upbringing have upon one's work, as well as the effect of location and its forces. He also examines influences — visual and connotative references — both English and historical.

Mutlow's work has predominately centered around the affordable house, and the development of a series of ideas over time.

OPTION B

Ferrante Room —

Scott L. Danielson, AIA, Technical Director of Architecture for Parsons Brinckerhoff in San Francisco, discusses two recent projects during his presentation on "The Use of Regional Design Themes." Danielson said, "I will cover two major points. The use of regional design themes in a quieter and richer way, including the suggestions that the hype of Post-Modernism and Contextualism, etc., may not be what our profession needs, and that there is an integral involvement of the broadest spectrum of fellow-disciplines in arriving at a design solution." To illustrate these issues, slides of the Ocean Transit Center and the West Seattle Bridge will be shown.

Danielson holds a B.A. in Architecture from M.I.T. His design experience includes projects for rapid transit systems, transportation and airport terminals, commercial,

industrial and institutional buildings, housing developments, recreational developments and shop facilities.

Stephen Gegner, AIA shares his own career developments during his presentation titled "From Apprentice to Award-Winning Employee." Gegner said, "My point will be how an architect/employee can maintain high goals, consistently execute quality design, get published, win awards and be successful." Presenting his experiences from the vantage point of an employee, he hopes his insights will benefit the great majority of AIA members — those architects who are employed by other architects.

Gegner has more than 20 years experience in architecture, encompassing the production of contract documents, the writing of specifications, contract administration, construction supervision and the design of various projects ranging from small scale residential and commercial to large scale institutional and town planning work.

Dennis Neeley, AIA and **Terry Lofrano, AIA** of Neeley/Lofrano Incorporated Architects in San Francisco, are joined by artist **William Spiegelhalter** to talk about the dramatic results of incorporating major artistic elements into a building's design from the earliest conception stages, during their

presentation on "Integrating Art with Architecture." Neeley said, "Most architects today are still seeing art as something to hang on the wall when the building is finished. We have worked closely with artist William Spiegelhalter and the results have been a real communication of each others' ideas and needs, and a real interchange and interplay, in which the ideas of one sparks new creative growth in the other."

Neeley is Vice President of the firm, which was founded in 1972. He is responsible for building design, financial investments and operations, drawing review and specification coordination and field observation.

Lofrano is President of the firm and is responsible for building design, working drawing production, drawing review and consultant coordination. The 12 person firm currently is working on a 56,000 sq. ft. commercial building with 56 condominiums, a 16,000 sq. ft. three-story office building, and a \$30 million convalescent hospital and residential care facility.

Spiegelhalter was born in Rochester, New York and raised in Erie, Pennsylvania. His educational background includes pre-med and Chinese language. He maintained a studio in Berkeley from 1970-1975, in which he offered design and tapestry classes and developed

his tapestry method as a means of artistic expression. He now resides in Gualala, California on the Mendocino coast. His works in tapestry, sculpture and serigraphs are in private and corporate collections.

Robert I. Hench, AIA, of the Blurock Partnership in Newport Beach, presents "Secrets of Success Resulting from Building Designs with Tight Parameters of Size, Shape, Budget, Scheduling Program, Materials, Energy Conservation and Seismic Design." The 50,000 sq. ft. Imperial County Administration Building, built to replace a building constructed in 1972 to the 1968 U.B.C. and destroyed in the October 1972 Imperial Valley earthquake, will be one of two brief case studies. The second is the Coastline Community College Center, a 50,000 sq. ft. administration building with strict design costs and time targets. Hench said, "The building was expected to look like a corporate headquarters yet be checked by the Office of the State Architect."

Hench holds a B.A. in Architecture from Syracuse University. Following five years of experience with the U.S. Army Corps of Engineers and with architectural firms in New York, Wisconsin and Beverly Hills, California, he joined the Blurock organization as a project architect.

He became a partner in 1968. Currently a senior partner, he has been responsible for guiding the programming, master planning, design, production and construction of schools

and colleges, public buildings, church architecture and transit facilities. He has developed special expertise in passive and active energy conserving building design.



William R. Glass, AIA

OPTION C

Colton Rooms —

William R. Glass, AIA, of Shen/Glass Architects in Berkeley, presents his firm's winning design of the "Math Sciences Research Institute Competition," staged by the University of California, Berkeley. The 22,000 sq. ft., \$2 million building will be organized around a three-story atrium space. Included in the facility will be a library, commons areas, a lecture hall and seminar room, administrative offices and 54 private offices for the members of the Institute.

Glass holds a B.A. in Architecture from U.C. Berkeley and received his Master of Architecture in Urban Design from Harvard Graduate School of Design. He has lectured at both U.C. Berkeley and Harvard, and served on the faculty of the AIA Energy in Architecture Program

in 1981. Prior to founding his firm in 1979, he worked for Bechtel, Inc.

Donald R. Lee, architect and associate partner of Langdon & Wilson Architects in Newport Beach, provides a mini case study of a four year long project, "The Hughes Aircraft Research Facility." He reveals the incredible challenges the three level, 2,341,000 sq. ft. laser research facility posed for the relatively small firm.

Lee joined the firm in 1975 and was appointed director of design in 1979. In 1981, he became an associate partner. He is a graduate of California Polytechnic State University, San Luis Obispo with a B.A. in Architecture and has a Master of Urban Planning/Design from the City University of New York.

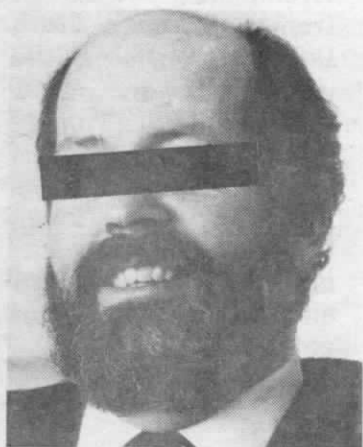

Dennis Neeley, AIA



Terry Lofrano, AIA

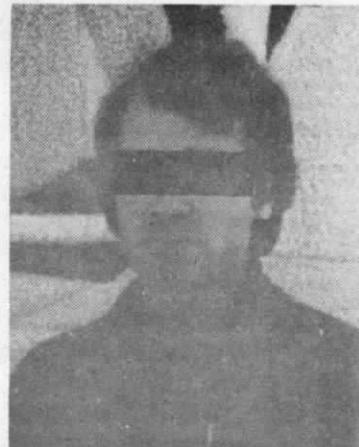

William Spiegelhalter



Robert I. Hench, AIA



Donald R. Lee

John K. Miller, FAIA, of Roland/Miller/Associates in Santa Rosa, speaks on "Process Design: Two California Wineries." Featured will be the Piper Sonoma Cellars and the Sonoma-Cutrer Winery. Miller is expected to reveal his secret for getting his client to let him design a winery when he hadn't designed one before, and he will explore the meaning of design anomalies and inconsistencies in architecture.

Miller, president of the 13 person design firm, has worked on large and small commercial and institutional designs, including housing. The firm's designs have received more than 30 local, regional and national design awards, and works have been published in *Architectural Record* and *Sunset*. He is a member of the CCAIA 1984 Honor Awards Committee, and Chairman of the Redwood Empire AIA 1984 Design Awards Committee.

Erik Sueberkrop, AIA, of Environmental Planning and Research, Inc. (EPR) in San Francisco, is joined by Roger Buckhout, Manager of Architectural Design and Construction for Apple Computer, during a presentation on "The Apple Computer Corporate Center." Sueberkrop said, "We came on the scene after the building shell had been leased by Apple. Except for the exterior walls, all interior and courtyard development was our responsibility." The building, completed in July, 1983, houses approximately 400 people in three stories and is 105,000 sq. ft.

Sueberkrop, currently project director for EPR, has extensive project management expertise in major projects for corporate, educational and institutional clients. Pre-



John K. Miller, FAIA



Erik Sueberkrop, AIA



Mark L. Fehlman, AIA



Ron Goldman, AIA

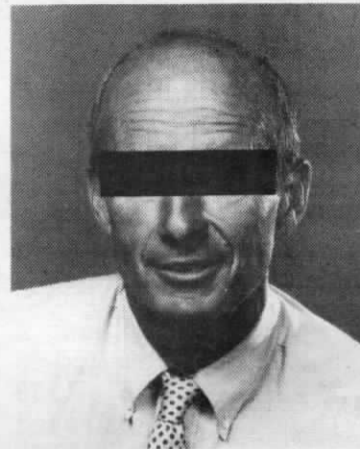

Herbert P. McLaughlin, AIA



Jeffrey Heller, AIA

vious project management responsibilities include a downtown pedestrian walkway for the Cincinnati Riverfront Stadium, and the redevelopment of the Union Station in Indianapolis into a specialty retail and ground transportation complex.

3:50 - 4:00 pm
EAVESDROPPING

4:00 - 5:20 pm
UNVEILING SECRETS

OPTION D

Steinbeck Forum -

Mark L. Fehlman, AIA, of Austin-Hansen, Inc./ AHVFRKA in Solana Beach, talks about how he gets his clients to draw out the best in him during "Captured Fantasies/Squeezing Juice." He will present work which illustrates how two of his clients' fantasies became realities.

Fehlman is a principal of the firm, which specializes in custom residential, multi-family residential and commercial projects. Prior to founding the firm, he

was head of PRC Tops, an architectural planning firm in La Jolla, and was responsible for designs of major recreation, housing and industrial facilities.

Ron Goldman, AIA, of Ron Goldman, AIA Architecture Planning in Malibu, shares his secrets on "Combining Architecture and Development." He has been successful in combining award-winning architecture, construction and development. Projects to be featured include commercial work ranging from a 12,000 sq. ft. shopping center to a 20 acre mixed-use town center, and residential projects ranging from a seven home single-family subdivision to a 22 unit condominium.

Goldman, a graduate of Princeton University and M.I.T., has received numerous CCAIA, local and national design awards. In addition to his architectural practice, Goldman heads a construction firm and a real estate development company.

Herbert McLaughlin, AIA and **Jeffrey Heller, AIA** of Kaplan/McLaughlin/Diaz in San Francisco, reveal

"Secrets to Working in the Public Realm." The presenters will discuss the firm's proven record in expeditiously getting regulatory approvals for housing projects, and its close working relationships with city planners from the inception of a project to promote clearer communications. They will present examples of how diversity in their work promotes the quality of design.

McLaughlin received his B.A. and Master of Architecture from Yale University. He has been a partner, responsible for research and design, since the inception of the firm in 1963.

Heller is a graduate of M.I.T. with a B.A. and Master of Architecture, and has extensive experience with high-rise and mixed-use projects. The firm currently is processing more major work with the City of San Francisco than any other firm. Projects now underway include four condominium developments totaling more than 2,500 units, three combined office/

hotel developments, two combined office/condominium projects, two hotel projects and five office buildings.

Ralph J. Roesling, AIA, **Kotaro Nakamura**, and **Chikako Terada** of Roesling-Nakamura and Partners in San Diego, will speak on "Effective Communications with Clients," or as Roesling said, "Architects Who Bathe Together Stay Together." The presentation will cover the use of study models as client-oriented tools for design, the importance of competitions in architecture, developing a closeness among design staff, and the influence of Minoru Takeyama's process and methods of design on their office. Takeyama is one of Japan's leading architects.

Roesling holds a B.A. in Architecture from Arizona State University and did graduate research in passive solar systems and testing. Prior to starting his own architectural firm, he worked for Innis-Tennebaum, Purcell & Rule and S.G.P.A.

Nakamura, a principal in the firm, was born in Shimane, Japan, and received his B.S. in Environmental Engineering from Kanto-Gakuin University and his Master of Arts in Art from San Diego State University.

Terada, a project designer with the firm, worked in Minoru Takeyama's office in Toyoko for two years. She received her B.A. in Architecture from Tama Art University and her M.A. in Environmental Design from San Diego State University. She is the winner of the 1981 Apartment of Tomorrow Competition which was published in the *Los Angeles Times*. The firm designs commercial, residential and institutional projects.

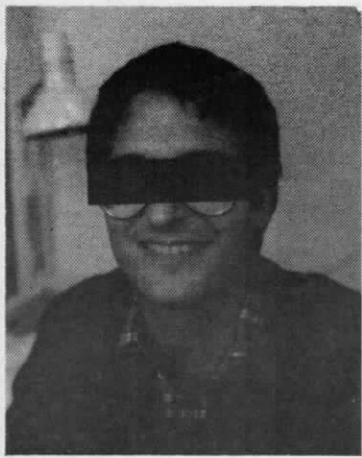

Ralph J. Roesling, AIA



Kotaro Nakamura



Chikako Terada



Michael O'Sullivan, AIA



John E. MacAllister, AIA



William D. Blackwell, AIA

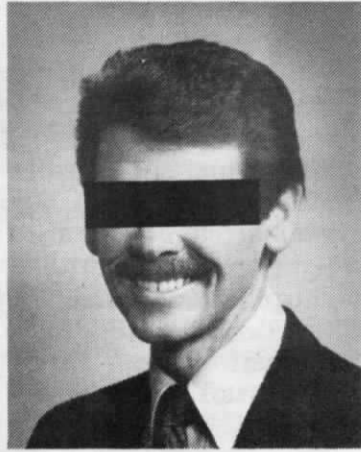

Scott Ellinwood, AIA

which combine affordable housing and energy efficient architecture. Current projects include a 138 unit affordable condominium project, and a 200 unit passive solar condominium project, of which 50 units will be affordable.

Michael O'Sullivan, AIA and **Malcolm Lewis, PE** will make a joint presentation on "Skylighting Secrets." O'Sullivan is director of design for Albert C. Martin & Associates in Los Angeles.

Lewis is a principal in the firm of Malcolm Lewis Associates in Los Angeles.

John ("Jack") E. MacAllister, AIA of Bobrow/Thomas and Associates (BTA) in Los Angeles, presents views on "Humanizing the Technical Environment." Increasingly, architects in the 1980's are designing sophisticated bio-medical and highly technical research facilities. As the programs for these buildings become more complex, they demand an architecture that is both innovative and responsive to future technical adaptations. MacAllister will discuss the scientific, aesthetic and social dimensions of a "technical architecture."

A principal of BTA, MacAllister received his B.A. in Architecture from the University of Pennsylvania, where he studied

under Louis I. Kahn. For 14 years, he served as principal architect at the firm of Louis I. Kahn, FAIA, with the responsibility for design development and documentation of Kahn's major projects. At BTA, he is involved in the new clinic for the U.S. Navy at Port Hueneme, California, the \$40 million downtown Los Angeles Veterans Administration Outpatient Clinic and the first combined Research/Clinical Biomedical Laser Laboratory at the University of California, Irvine.

not only the vehicle, but the directions inspired by having control over one's destiny.

Kaplan, who has been practicing architecture for more than 11 years, said he knew at age 6 what he wanted most: to practice design and architecture. After graduating from the University of Washington with a Bachelor of Architecture Degree, he traded in his motor board for a hard hat and learned architecture in the field. The firm was established in 1972, and is best known for achievements in the residential sector. However, the firm also has been involved in commissions for a youth camp, a factory/office complex, and a designer showroom. New projects include restaurants, a retail store and several new houses and multi-family units. The firm is the recipient of five AIA honors, including the Western Region AIA Honor Award in the 1982 Energy in Design Awards Program.

OPTION E

Ferrante Rooms —

William D. Blackwell, AIA of William D. Blackwell, AIA in Piedmont, tells how to proportion rooms for best use of materials, how to put a round dome on a square base, and other secrets during his presentation titled "Geometry in Architecture." The author of a recently published book by the same title argues that architecture and geometry are virtually inseparable, and together they form a powerful union of creativity and discipline, the one the instrument of the other, a balance of imagination and exacting realism.

Blackwell, a project architect for Bechtel Companies, has served as project architect for the WIPP Project, an underground repository for nuclear waste, as manager of architecture for airport projects in Amman, Jordan, and as staff specialist in the architectural design of nuclear and fossil-fueled power plants.

Scott Ellinwood, AIA, of Scott Ellinwood & Associates in Ventura, addresses the issue of "Resource Conscious Architecture." Far more than energy efficiency, resource conscious architecture embraces such concerns as the functional efficiency of a building, the environment created for those using the building. Water conservation, air pollution, and efficient land use, as well as energy use, are serious concerns for governmental agencies who must give their approval before a project can be built. He said, "By maintaining a state of the art expertise in the ways architecture and planning can address these concerns, one is able to balance his design solutions to mitigate these concerns and meet the client's needs."

Ellinwood received his degree in Architecture from the University of Michigan and was selected to be the first U.S. Peace Corps architect in Brazil. In 1982, he formed his own firm to pursue more actively projects

OPTION F

Colton Rooms —

Martin Henry Kaplan, AIA, of Martin Henry Kaplan Architect AIA in Seattle, reveals the secret to inspiring, establishing and controlling one's own destiny as an architect or designer during his presentation "Practicing Architecture As You Wish and Dream." Specific work and the philosophy behind its conception, design and completion will be presented which describes

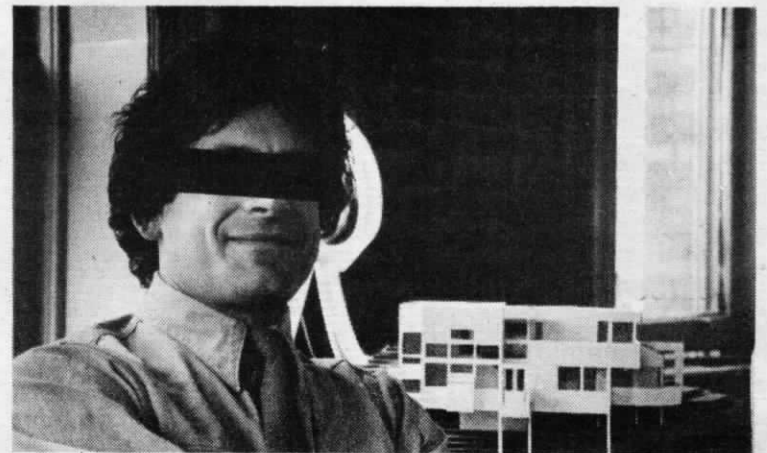

Martin Henry Kaplan, AIA

Glenn Lym, project architect for Esherick Homsey Dodge and Davis in San Francisco, talks about "When the Image Becomes a Design Problem." In recent years, the firm has had several large commissions in which the owners have imposed very strong, but vaguely defined building image pre-conceptions. His presentation will focus on several ski lodges and housing at Deer Valley in Park City, Utah. He will discuss the secrets of working with owner's pre-conceptions while shaping buildings that respond to complex program site and climate demands.

Lym, a licensed architect in California since 1980, has worked on the Monterey Bay Aquarium, now under construction and the Fillmore Center, a commercial/entertainment block for the San Francisco Redevelopment Agency, and participated in the design for the San Francisco Zoo Gorilla Exhibit. He is a graduate in architecture from U.C. Berkeley and holds a Ph.D. in Social Psychology from Harvard University. Lym is the author of *A Psychology of Building*.

Carl L. Strona, AIA, of Olsen Strona Architecture & Planning in San Diego, talks about "Designing It the Old Fashioned Way - Stealing It." Strona joked, "I can't help it; I'm Italian." He explained the firm's approach to avoiding

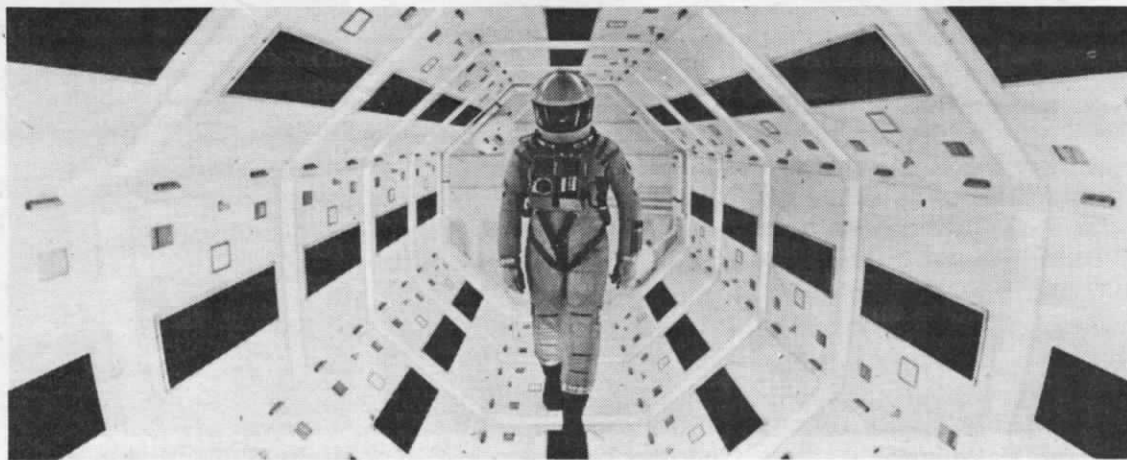

William Brierlye Tomlinson

costly details, concentrating instead on active spaces, proportions, light, shadow and function. "We love stucco. It fits our San Diego heritage. It fits my heritage. Out of stucco you can sculpt an object/ space as if carving it from cheese," he added.

Strona is a graduate of the University of Pennsylvania Graduate School of Fine Arts with a Master of Architecture degree. He has held the position of Chairman of the Department of Architecture and Environmental Design at San Diego Mesa College since 1981. The firm of Olsen Strona was established in 1972; its project types include recreational facilities, residential and commercial.

William Brierlye ("Brier") Tomlinson, of Fisher-Friedman Associates in San Francisco, uncovers "Architecture of a Future Past." He discusses the film *2001: A Space Odyssey*, and the thesis that it represents a reincarnation of Classicism in the projected

Modernism of its settings, the two of them together masquerading as a vision of the future. Tomlinson said, "We are accustomed to thinking of Modernism as revolutionary, thanks to decades of impassioned rhetoric. In *2001*, however, director Stanley Kubrick uses the ideal eye of the camera to reveal the Renaissance structures beneath the surface of his seamless future Modernism."

Tomlinson received his Master of Architecture degree from Carnegie-Mellon University. His recent work includes production and drafting with the firm of Stoller & Ong for a student housing project for San Jose State University and work with Stoller & Ong and the office of Jaques DeBrer to develop a submission for the University of California Santa Barbara Museum Competition.

5:20 - 5:30 pm
EAVESDROPPING

5:30 - 5:45 pm
**ILLUMINATIONS:
A NEON SYMPHONY**

Steinbeck Forum -

Architect **Milford Wayne Donaldson, AIA** and **Juliette Mondot**, artist and co-founder of Save Our Neon Organization (SONO) shed light on the vibrant San Diego organization.

Donaldson, President of Sixteen Penny Construction, received a Bachelors Degree in Architecture and Construction Management from California Polytechnic University at San Luis Obispo, and holds a Master of Science Degree from the University of Strathelyde, Glasgow, Scotland. He is a licensed architect and contractor, and has focused his work on historic rehabilitation in San Diego's Historic Gaslamp Quarter.

Mondot holds a B.A. degree in Art from the University of California at Santa Cruz and an M.F.A. from Cal Arts, Valencia, California. She has extensive background in photography, videotape production and computer services, and in 1971 served as production assistant to George Macunias for Yoko Ono's art show at the Everson Museum.

5:45 - 6:30 pm
POTIONS AND ELIXIRS

DeAnza Lobby -

Cash Bars available for your refreshment needs....

6:30 pm
HONOR AWARDS ROAST

Serra Ballroom II -

Bernard Zimmerman, FAIA bestows the honors as master of ceremonies for the 1984 CCAIA Honor Awards dinner. A dinner you simply must see to believe will be served at 7:00 pm, followed by a slide presentation of the award-winning projects. **James Pulliam, FAIA**, chair of the 1984 CCAIA Honor Awards Program Committee, will join CCAIA President **Harry Jacobs, AIA** in presenting the award certificates. In addition to recognizing specific projects for design excellence, this year's program will feature the first CCAIA Firm Award, presented to a California firm whose continuing collaboration among individuals has been the principal force in consistently producing distinguished architecture for a period of at least 10 years.

Awards jurors **W. C. Muchow, FAIA** of W. C. Muchow and Partners, Inc. in Denver, Colorado, and **David H. Wright, AIA**, of The Bumgardner Architects in Seattle, Washington, will show slides of the winning projects and discuss their reasons for selecting the winners.



Glenn Lym



Carl L. Strona, AIA



Juliette Mondot



W. C. Muchow, FAIA

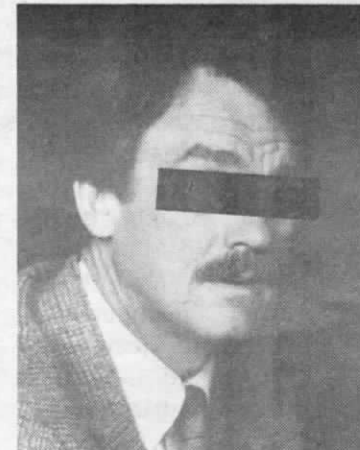

David H. Wright, AIA

Special Feature

1984 CCAIA Honor Awards Winners Revealed

In recognition for excellence in architectural design, the California Council, The American Institute of Architects will present the 1984 CCAIA Honor Awards at a special dinner on Friday, March 30.

William C. Muchow, FAIA, W. C. Muchow & Partners, Inc., Denver, Colorado, **David H. Wright, AIA**, The Bumgardner Architects, Seattle, Washington, and **Dan Kiley**, Landscape Architect, Charlotte, Vermont, served as the jury for the prestigious awards program.

Winners of the Firm Award, Honor Awards and Merit Awards are:

FIRM AWARD: Presented to a California firm in which continuing collaboration among individuals has been the principal force in consistently producing distinguished architecture for a period of at least ten years.

MARQUIS ASSOCIATES, San Francisco, CA

MBT ASSOCIATES, San Francisco, CA

HONOR AWARDS: Presented for design excellence to licensed members of the CCAIA for projects located anywhere in the world, and to AIA members licensed in other states for projects located in California.

Ahmadu Bello University Theatre Workshop Zaria, Nigeria, Africa. **STEVEN D. EHRlich, AIA, ARCHITECT** Venice, CA

Galaxy Theater San Francisco, CA **KAPLAN/McLAUGHLIN/DIAZ** San Francisco, CA

Cleveland Arcade Cleveland, Ohio **KAPLAN/McLAUGHLIN/DIAZ** San Francisco, CA

George R. Moscone Convention Center San Francisco, CA **HELLMUTH, OBATA & KASSABAUM, INC.** San Francisco, CA

King Khaled International Airport Riyadh, Saudi Arabia **HELLMUTH, OBATA & KASSABAUM** San Francisco, CA

The College Preparatory School Oakland, CA **DUTCHER AND HANF, ARCHITECTS** Berkeley, CA

Malibu Cove Residence Malibu, CA **RON GOLDMAN, AIA** Malibu, CA

Crocker Center and Galleria San Francisco, CA **SKIDMORE, OWINGS & MERRILL** San Francisco, CA

The Federal Reserve Bank of San Francisco San Francisco, CA **SKIDMORE, OWINGS & MERRILL** San Francisco, CA

Washington-Battery Street Office Building San Francisco, CA **FEE + MUNSON ARCHITECTS** San Francisco, CA, in association with **SIDNEY HOOVER, ARCHITECT**

MERIT AWARDS:

St. Mathew's Parish Church Pacific Palisades, CA **MOORE RUBLE YUDELL** Marina del Rey, CA

Roberto Adobe Restoration San Jose, CA **GILBERT ARNOLD SANCHEZ ARCHITECTS, INC.** San Jose, CA

Design Professionals Insurance Company Headquarters Monterey, CA **MARQUIS ASSOCIATES** San Francisco, CA

Rare Books and Manuscripts Library Palo Alto, CA **MARQUIS ASSOCIATES** San Francisco, CA

The Stern Building at Levi Plaza San Francisco, CA **GENSLER & ASSOCIATES/ARCHITECTS** San Francisco, CA

Giftcenter San Francisco, CA **KAPLAN/McLAUGHLIN/DIAZ** San Francisco, CA

Residence for Lillie Leonard and Charles Hunt Occidental, CA **DUTCHER AND HANF, ARCHITECTS** Berkeley, CA

Malibu Colony Residence Malibu, CA **RON GOLDMAN, AIA** Malibu, CA

Angelus Plaza Elderly Housing Complex Los Angeles, CA **DANIEL L. DWORSKY FAIA & ASSOCIATES, INC.** Los Angeles, CA

Chabot Center Pleasanton, CA **FEE + MUNSON ARCHITECTS** San Francisco, CA

Hughes EDSG El Segundo, CA **LANGDON, WILSON, MUMPER, ARCHITECTS** Newport Beach, CA

Greystone Las Vegas, Nevada **LEASON POMEROY ASSOCIATES, INC.** Orange, CA

The Atrium at the Mall at 163rd Street Miami, Florida **CHARLES KOBER ASSOCIATES and WOLFBERG ALVAREZ TARACIDO & ASSOCIATES** Los Angeles, CA

High Meadow Outlook Townhouses Carmel, CA **HALL GOODHUE HAISLEY AND BARKER** Monterey, CA

"Pig with a Purple Eye Patch" San Diego, CA **PACIFIC ASSOCIATES PLANNERS ARCHITECTS, INC.** San Diego, CA

Margaret S. Hayward Playground Building San Francisco, CA **WILLIS AND ASSOCIATES** San Francisco, CA

"SECRETS" Program

Saturday, March 31, 1984

7:30 - 8:00 am
EATABLE EVIDENCE
Steinbeck Lobby -

You, too, can be an accomplice to the consumption of coffee and danish...

8:00 - 8:50 am
KA MEA HUNA
Steinbeck Forum -

Christopher J. Smith, AIA, President of the Hawaii Society AIA, will be joined by **Joseph Farrell, AIA** of Architects Hawaii Ltd. of Honolulu, and others to speak about the elements that influence the Pacific Basin's regional architecture. Smith said, "The Hawaiian Islands, starting with the 1820 New England fervor for religious expansion, have seen great environmental changes. The grass hut and native life has been replaced by Honolulu's high-rise cosmopolitan society, and the neighbor islands' well-developed rural tourist facilities and comfortable life." On behalf of the Hawaii Society AIA, Smith will moderate a presentation of built environments selected to show how the past has influenced the evolution of today's forms and spaces.

Smith, President of The CJS Group-Architects, Ltd. in Honolulu, was educated at California State Polytechnic University at San Luis Obispo, receiving degrees in both Architecture and Social Science. He has received numerous AIA design awards and several private and public grants for study of urban problems. Smith also serves on several city and county committees in Hawaii.

Farrell is the owner/director of his firm, which specializes in marketing and design. His work includes almost every kind of building type and interiors. He has designed more than 3,500,000 net sq. ft. in office projects, plus five banks, and is credited with having designed more office buildings in the central business and governmental districts than any other architect in Honolulu.

8:50 - 9:00 am
EAVESDROPPING

9:00 - 9:50 am
WHO'S BEEN FRAMED
Steinbeck Forum -

Ed Carpenter of Portland is a glass artist who designs windows for public



Christopher J. Smith, AIA



Ed Carpenter



Jane Lidz



Janice Phillip

spaces throughout the country. He will discuss projects which have required him to work closely with architects, and show examples of his work. Presently, his projects include a courthouse and a performing arts center in Oregon, a community center in California, and a church in Texas.

Carpenter studied architectural glass design in England and Germany under a grant from the Graham Foundation for Advanced Study in the Fine Arts. He has lectured on glass in New Zealand as a guest of the New Zealand Glass Artists Society, and has authored articles for Smithsonian, Crafts, Glass, and Glass Art. Currently he serves on the board of the American Crafts Council.

Many of Carpenter's designs are executed by Tim O'Neill, master glass craftsman from Troutdale, Oregon. Carpenter said, "When the rain lets up in Oregon, I'm usually backpacking, bicycling or canoeing; otherwise, I'm baking or dreaming about chocolate eclairs."

**9:50 - 10:00 am
EAVESDROPPING**

**10:00 - 10:50 am
THE MISSING
DIMENSION**

Steinbeck Forum —

An editor of a major architecture journal said recently, "We don't publish great architecture, we publish great photographs of great architecture." Panelists **Jane Lidz**, architectural photographer, **Janice Phillip**, editor of Architecture California, and **Kenneth R. Windsor**, art director of Progressive Architecture, discuss the impact media has on the way people perceive architecture.

According to Lidz, with each decision about lighting, people, propping, and cropping, another statement is being made about the design and its appeal to magazine readers, future clients, and competition juries. Lidz said, "I strive to make photographs which successfully convey the architect's concepts, and give information, pleasure and inspiration."

Lidz was recently awarded a Loeb Fellowship at the Harvard Graduate School of Design, and is continuing her research on water and architecture. Her photographs have been published in Architecture, Architectural Record, Designer's West, House Beautiful and Progressive Architecture. She holds a Master of Architecture degree from the University of Oregon, and is the author of Rolling Homes: Handmade Houses on Wheels, which was nominated for a national book award.

Phillip is a writer and photographer with a talent for originating magazines. She currently is editor of Architecture California, the official publication of the California Council, The American Institute of Architects. Phillip will talk about why certain projects are selected for an architectural publication, and how a three dimensional built work is transferred to a one dimensional page.

Windsor, formerly a designer of books for the art book publishing firm of Harry N. Abrams, Inc., joined the staff of Progressive Architecture in October 1983. He received a B.A. in Religion and Art from the University of California San Diego, and a Bachelor of Design degree from Bezalel Academy of Art and Design in Jerusalem, Israel.

**10:50 - 11:00 am
EAVESDROPPING**

**11:00 - 11:50 am
THE ARCHITECTURE
IN ART**

Steinbeck Forum —

Mary Livingstone Beebe, director of The Stuart Collection, takes an architectural look at contemporary sculpture. "In working on site-specific projects for The Stuart Collection, a new program commissioning

contemporary sculpture for the U.C. San Diego campus, some of the artists are thinking architecturally. Working in collaboration or independently, many sculptors and architects are confronting similar issues and constraints. Consider: space, scale, passage, entrance, exit, front, back, codes, earthquakes and drainage," Beebe said.

Beebe received a B.A. in Political Science from Bryn Mawr College in Pennsylvania, and attended Sorbonne, University of Paris. She has experience as a museum apprentice, curatorial assistant and public relations director. Prior to accepting the position of director of The Stuart Collection, she was the executive director for the Portland Center for the Visual Arts.

**12:00 Noon
INTIMATE
ARCHITECTURE
LUNCHEON**

DeAnza Ballrooms —

Robert McDonald, director of The Art Museum of Santa Cruz County, speaks on fashion design, and presents unique examples of wearable art. McDonald says an all-inclusive aesthetics in art-making is a phenomenon that increasingly has demanded recognition. Old hierarchical categories such as arts and crafts, the former superior and the latter inferior, are no longer appropriate. Increasingly, too, the barriers among the traditional arts

have become irrelevant. The enduring criterion for art, whatever its form, is that it enhances life as a celebration of creativity itself, whatever forms it might take. Fashion is an art form in which "traditional" arts and crafts meet in mutually nourishing relationships. It is also an art form that confronts many of the same problems and shares many of the same principles as architecture.

McDonald held the position of Chief Curator at the La Jolla Museum of Contemporary Art from 1979 to 1982. Prior to that he was the Administration Assistant to the Director of the University Art Museum at the University of California in Berkeley.

Also assisting with the luncheon program is **Beth Regardz**, graphics and interiors designer.

**2:00 - 3:20 pm
UNVEILING SECRETS**

See Friday Program 2:30 - 3:50 pm for descriptions.

OPTION A

Steinbeck Forum —

Richard P. Dalrymple, AIA; Steven D. Ehrlich, AIA; Wade Killefer, AIA; and John V. Mutlow, AIA

OPTION B

Ferrante Rooms —

Scott L. Danielson, AIA; Stephen Gegner, AIA; Dennis Neeley, AIA/Terry Lofrano, AIA/William Spiegelhalter; and Robert I. Hench, AIA



Mary Livingstone Beebe



Robert McDonald

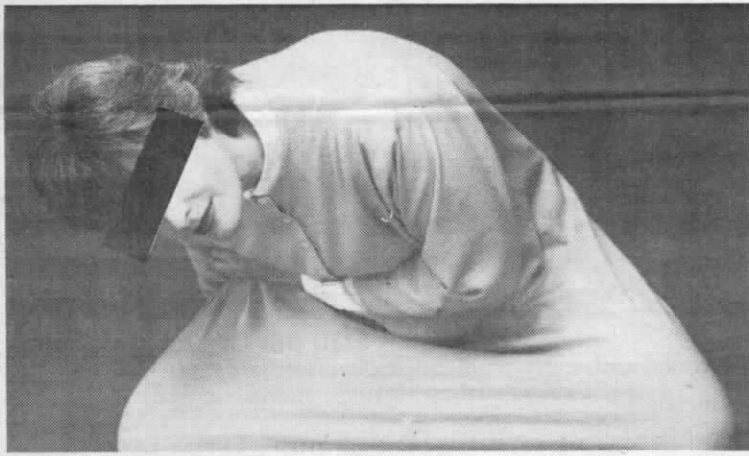

Beth Regardz

OPTION C

Colton Rooms —
William R. Glass,
AIA; Donald R. Lee,
AIA; John K. Miller,
FAIA; and Erik Sueber-
krop, AIA

3:20 - 3:30 pm
EAVESDROPPING

3:30 - 4:50 pm
UNVEILING SECRETS
See Friday Pro-
gram 4:00 - 5:20 pm
for descriptions.

OPTION D

Steinbeck Forum —
Mark L. Fehlman,
AIA; Ron Goldman,
AIA; Herbert P. Mc-
Laughlin, AIA/Jeffrey
Heller, AIA; and
Ralph J. Roesling,
AIA/Kotaro Nakamura/
Chikako Terada

OPTION E

Ferrante Rooms —
William D. Black-
well, AIA; Scott Ellin-
wood, AIA; Michael
O'Sullivan, AIA/ Mal-
colm Lewis, PE/; and
John E. MacAllister,
AIA

OPTION F

Colton Rooms —
Martin Henry Kap-
lan, AIA; Glenn Lym;
Carl L. Strona, AIA;
and William Brierlye
Tomlinson

5:00 - 6:00 pm
RUMORS, POTIONS
AND ELIXIRS
Steinbeck Lobby —

Libations will flow
and the grapevine will
hum as secrets about
famous and infamous
designers are dis-
closed. CCAIA is not
responsible for insinua-
tions, white lies, un-
truths and rumors...

"SECRETS" Program

Sunday, April 1, 1984

8:30 - 9:00 am
EATABLE EVIDENCE
Steinbeck Lobby —

Quick, grab the
goods before the
program starts ... you
take the coffee and I'll
take the muffins.

9:00 - 12:00 noon
RIDDLES, SLY SOLU-
TIONS AND THE TIP
OFF
Steinbeck Forum —

Informants leak
the facts necessary to
solve the puzzle of
design competitions
during this three-part
program.

Part I - Alternatives to
Traditional Design
Competitions

Sherwood Stock-
well, FAIA and Henrik
H. Bull, FAIA, princi-
pals of Bull Volkmann
Stockwell in San Fran-
cisco, and Terence N.
Ainscow, AIA of the
Syntex Corporation,
form a team to explore
alternatives to typical
open competitions.
The pros and cons of
limited competitions
and professional juries
are argued.

Stockwell received
his Bachelor of Archi-
tecture degree from
M.I.T. He is active in
public service in San
Francisco and was the
founding director of
the California Planning
and Conservation
League. His work has
been published in major
local, regional and
national magazines,
and he has received a

number of AIA honor
awards. Projects in-
clude industrial, com-
mercial, residential
and hotel/resort
facilities.

Bull also received
his Bachelor of Archi-
tecture degree from
M.I.T. He has had
personal involvement
in design of projects
receiving over thirty
major design awards in
AIA-sponsored pro-
grams. He also has
served on juries for the
AIA/Sunset Magazine
Western Home Awards
and for Cedar Shingle
and Shake Bureau in
California, as well as
AIA Awards programs
in Portland, Santa
Barbara, Hawaii and
San Diego.

Ainscow graduated
with a Master's Degree
in Architecture from
the University of
Pennsylvania, where he
studied under Louis
Kahn and Romaldo
Giurgola. He was
recently the profes-
sional advisor for a
limited competition to
master plan Syntex'
newly acquired, 165
acre site.

Part II - Competitions
Compared: University
of California Santa
Barbara Art Museum
and Triton Museum of
Art

The professional
advisor for the
University of Cal-
ifornia Santa Barbara
Art Museum Competi-
tion and Santa Clara
Valley's Triton Museum
of Art Competition,
William H. Liskamm,
FAIA, compares both
the methods and re-
sults of these two re-
cent California art
museum competitions.



Wayne Barcelon

The team of
Michael Dennis, Jef-
frey Clark, Greg Con-
yngham and Gary La-
pera was selected from
256 entries to design a
\$5.3 million, 18,270 sq.
ft. art museum and
campus gallery space
for the University of
California Santa Bar-
bara. All entries were
submitted anonymously,
allowing each to be
judged on merit, rather
than on a firm's name
or prestige. Director
of the University of
California Santa
Barbara Art Museum
Dr. David Farmer, who
served as sponsor for
the Museum Competi-
tion, describes the
user's perspective of
competitions as a
means to select a
design and a designer.

The elements for
the university museum
include a 100-seat
lecture hall, a 3,190 sq.
ft. program and re-
search area for prints,
graphic arts and archi-
tectural drawings, and
administrative and gal-
lery services spaces.

Also joining Lisk-
amm will be architect
Wayne Barcelon, prin-
cipal of Barcelon +
Jang, who will review
his firm's winning
design of the Triton

Museum of Art, and
C. David Robinson,
AIA of Robinson Mills
and Williams, a finalist
in the competition.

The competition,
underwritten by a
\$27,500 grant from the
National Endowment
for the Arts, received
45 direct proposals.
Five Bay Area finalists
were selected to partici-
pate in a three day,
on-site charrette to
further develop plans
for the \$4 million
project. The program
for the 33,000 sq. ft.
main building included
consideration of the
parksite, accommoda-
tion of existing build-
ings, energy conserva-
tion, controlled light
and possibilities for
phased construction.

Barcelon establish-
ed the firm of Barcelon
+ Jang in 1976, with an
emphasis on program
development and feasi-
bility studies as related
to short and long range
planning goals. Repre-
sentative projects
include the San Fran-
cisco Chinatown Circu-
lation Study; Capitol
Plaza highrise mixed
use development proj-
ect; and Kaiser Founda-
tion Hospital, San
Francisco Medical
Center.



Sherwood Stockwell,
FAIA



Henrik H. Bull, FAIA



Terence N. Ainscow,
AIA, RIBA

Program-At-A-Fleeting-Glance

Michael Patrick Porter, Assistant Planner for the City of San Juan Capistrano, will present an overview of the process and submissions for the San Juan Capistrano Library Competition. Charles Moore, Robert A. M. Stern and Michael Graves were the three architects selected from among forty designers who submitted qualifications for the award of contract. Two of the solutions were interesting, the third caused a stir, according to Porter. Porter will focus on how the scheme by Michael Graves, FAIA was chosen, the changes which took place in the design, and the reaction of the community to the built project. Porter said, "I will answer the often asked question: Will we do it again?"

Porter received his Bachelor of Science in Urban Planning from California State Polytechnic University Pomona in 1977. In 1983, he became managing partner in the firm of Pendleton/Porter Architecture and Planning.

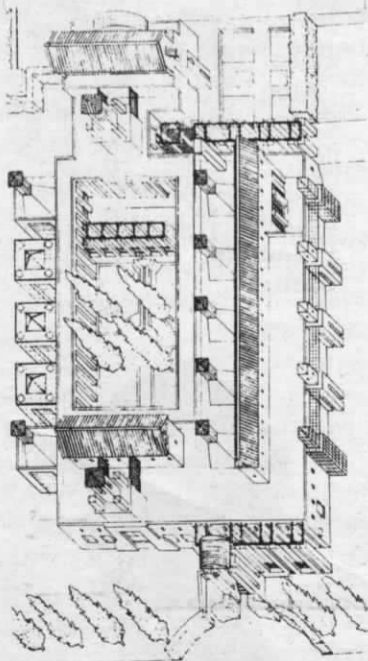

Friday, March 30

- 1:00 pm - Steinbeck Forum
CONFESSIONS
Harry Jacobs, AIA
Ed Sohl, AIA
- 1:20 pm - Steinbeck Forum
IN THE DARK
- 1:30-2:15 pm - Steinbeck Forum
ILLUSIONS
Robert Israel
- 2:15-2:30 pm
EAVESDROPPING
- 2:30-3:50 pm - Three Options
UNVEILING SECRETS
 Steinbeck Forum:
Richard P. Dalrymple, AIA;
Steven D. Ehrlich, AIA; Wade
Killefer, AIA; and **John V.**
Mutlow, AIA

Ferrante Rooms:
Scott L. Danielson, AIA;
Stephen Gegner, AIA; Dennis
Neeley, AIA/Terry Lofrano,
AIA/William Spiegelhalter;
 and **Robert I. Hench, AIA**

Colton Rooms:
William R. Glass, AIA; Donald
R. Lee; John K. Miller, FAIA;
 and **Erik Sueberkrop, AIA**

- 3:50-4:00 pm
EAVESDROPPING
- 4:00-5:20 pm - Three Options
UNVEILING SECRETS
 Steinbeck Forum:
Mark L. Fehlman, AIA; Ron
Goldman, AIA; Herbert P.
McLaughlin, AIA/Jeffrey Hel-
ler, AIA; and **Ralph J.**
Roesling, AIA/Kotaro Naka-
mura/Chikako Terada

Ferrante Rooms:
William D. Blackwell, AIA;
Scott Ellinwood, AIA; Michael
O'Sullivan/Malcolm Lewis, PE;
 and **John E. MacAllister, AIA**

Colton Rooms:
Martin Henry Kaplan, AIA;
Glenn Lym; Carl L. Strona,
AIA; and **William Brierlye**
Tomlinson

- 5:20-5:30 pm
EAVESDROPPING

- 5:30-5:45 pm - Steinbeck Forum
ILLUMINATIONS: A NEON
SYMPHONY
M. W. Donaldson, AIA
Juliette Mondot
- 5:45-6:30 pm - DeAnza Lobby
POTIONS AND ELIXIRS
- 6:30 pm - Serra Ballroom II
HONOR AWARDS ROAST

Saturday, March 31

- 7:30-8:00 am - Steinbeck Lobby
EATABLE EVIDENCE
- 8:00-8:50 am - Steinbeck Forum
KA MEA HUNA
Christopher J. Smith, AIA
Joseph Ferrell, AIA
- 8:50-9:00 am
EAVESDROPPING
- 9:00-9:50 am - Steinbeck Forum
WHO'S BEEN FRAMED
Ed Carpenter
- 9:50-10:00 am
EAVESDROPPING
- 10:00-10:50 am - Steinbeck Forum
THE MISSING DIMENSION
Jane Lidz
Janice Fillip
Kenneth R. Windsor
- 10:50-11:00 am
EAVESDROPPING
- 11:00-11:50 am - Steinbeck Forum
THE ARCHITECTURE IN
ART
Mary Livingstone Beebe
- 12:00 noon - DeAnza Ballrooms
INTIMATE ARCHITECTURE
LUNCHEON
Robert McDonald
Beth Regardz
- 2:00-3:20 pm - Three Options
UNVEILING SECRETS
 Steinbeck Forum:
Richard P. Dalrymple, AIA;
Steven D. Ehrlich, AIA; Wade
Killefer, AIA; and **John V.**
Mutlow, AIA

Ferrante Rooms:
Scott L. Danielson, AIA;
Stephen Gegner, AIA; Dennis
Neeley, AIA/Terry Lofrano,
AIA/William Spiegelhalter;
 and **Robert I. Hench, AIA**

Colton Rooms:
William R. Glass, AIA; Donald
R. Lee; John K. Miller, FAIA;
 and **Erik Sueberkrop, AIA**

- 3:20 - 3:30 pm
EAVESDROPPING
- 3:30-4:50 pm - Three Options
UNVEILING SECRETS
 Steinbeck Forum:
Mark L. Fehlman, AIA; Ron
Goldman, AIA; Herbert P.
McLaughlin, AIA/Jeffrey Hel-
ler, AIA; and **Ralph J.**
Roesling, AIA/Kotaro Naka-
mura/Chikako Terada

Ferrante Rooms:
William D. Blackwell, AIA;
Scott Ellinwood, AIA; Michael
O'Sullivan/Malcolm Lewis, PE;
 and **John E. MacAllister, AIA**

Colton Rooms:
Martin Henry Kaplan, AIA;
Glenn Lym; Carl L. Strona,
AIA; and **William Brierlye**
Tomlinson

- 5:00-6:00 pm - Steinbeck Lobby
RUMORS, POTIONS AND
ELIXIRS

Sunday, April 1

- 8:30-9:00 am - Steinbeck Lobby
EATABLE EVIDENCE
- 9:00-Noon - Steinbeck Forum
RIDDLES, SLY SOLUTIONS
AND THE TIP OFF
 Part I
Alternatives to Traditional
Design Competitions
Sherwood Stockwell, FAIA
Henrik H. Bull, FAIA
Terence N. Ainscow, AIA
- Part II
Competitions Compared: U.C.
Santa Barbara Art Museum and
Triton Museum of Art
William H. Liskamm, FAIA
Dr. David Farmer
Wayne Barcelon
C. David Robinson, AIA
- Part III
Built Evaluation: San Juan
Capistrano Library
Michael Patrick Porter
- Noon
THE VANISHING ACT